

MEGAPIX

IP Cameras









5MP model	2.1MP/1080p model
DWC-MF5Wi4TWDMP	DWC-MF2Wi4TWDMP

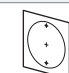

MEGAPIX

Provides Visual Confirmation for Your Alarm System

UL LISTED

WHAT'S IN THE BOX					
Quick Setup and Download Guides		1 set	Moisture Absorber and Guide (Recommended)		1 set
Star Wrench (T-20)		1	Mounting Bolt and Nuts - 2pcs		1 set
Mounting Template for Bolt and Nuts Installation		1	Screws and Plastic Anchors - 3pcs		1 set
Mounting Template for Plate Installation		1	Mounting Plate		1
Waterproof Cap and Rubber Rings (Black: ø0.15" (ø4mm), White: ø0.19" (ø5mm))		1 set			

**NOTE:** Download all your support materials and tools in one place

1. Go to: <http://www.digital-watchdog.com/resources>

2. Search your product by entering the part number in the 'Search by Product' search bar. Results for applicable part numbers will populate automatically based on the part number you enter.

3. Click 'Search'. All supported materials, including manuals and quick start guide (QSGs) will appear in the results.



**Attention:** This document is intended to serve as a quick reference page for the initial setup. It is recommended that the user read the entire instruction manual for complete and proper camera usage.

Tel: 866-446-3595 / 813-888-9555

digital-watchdog.com

Technical Support Hours:  
9:00 AM – 8:00 PM EST, Monday through Friday

MEGAPIX

Quick Start Guide

STEP 1 – PREPARING TO MOUNT THE CAMERA

1. The mounting surface must withstand five times the camera weight.
2. Do not let the cables get caught in improper places or the electric line cover can be damaged. This may cause a short or fire.
3. CAUTION: These servicing instructions are for use by qualified service personnel only. To reduce the risk of electric shock do not perform any servicing other than that contained in the operating instructions unless you are qualified to do so.
4. This product is intended to be supplied by a UL Listed Power Supply Unit marked “Class 2” or “LPS” or “PS2” and rated 12 Vdc, 0.49A (DWC-MF5Wi4TWDMP) and 0.33A (DWC-MF2Wi4TWDMP) min.
5. The wired LAN hub providing power over the Ethernet (PoE) in accordance with IEEE 802-3af shall be a UL Listed device with the output evaluated as a Limited Power Source as defined in UL60950-1 or PS2 as defined in UL62368-1.
6. Unit is intended for installation in a Network Environment 0 as defined in IEC TR 62102. As such, associated Ethernet wiring shall be limited to inside the building.
7. For the installation process, remove the dome cover from the camera module by loosening the three (3) screws on the dome. Use the wrench provided with the camera.
8. Install the moisture packet in the base of the camera's lens.
  - a. Remove the moisture absorber from the packaging.
  - b. Cut the card and folder along the dotted line.
  - c. Place the moisture absorber around the camera's lens module.

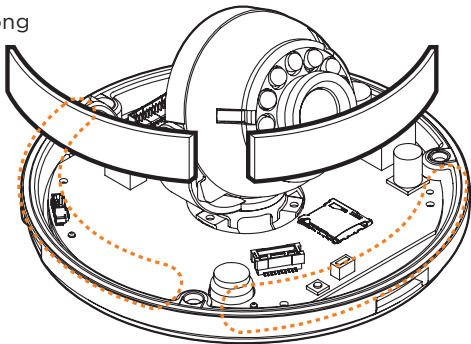

**NOTE:** The camera will generate enough heat to dry moisture during operation. In most cases it will not need the moisture absorber for more than the first day. In cases where the camera can experience a moisture issue, users must keep the moisture absorber in the camera. The moisture absorber has an approximately 6-month life cycle, varying depending on the environment.

**WARNING:** It is highly recommended that you install the moisture absorber when mounting the camera. The moisture absorber prevents moisture from being captured inside the camera's housing, which may cause image performance issues and damage the camera.

9. Remove the protective film between the dome and the camera module.
10. Remove the Poron Ring before placing the dome back on the camera. When attaching the dome back, align the line on the dome with the one on base of the camera.
11. Using the mounting template sheet or the camera itself, mark and drill the necessary holes in the wall or ceiling.

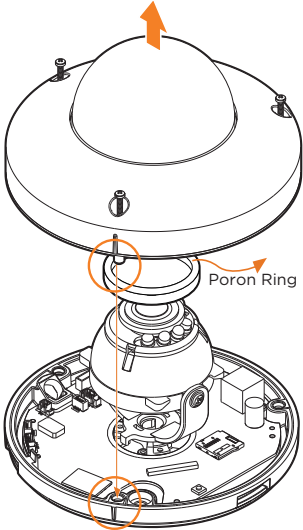

STEP 2 – POWERING THE CAMERA

Pass the wires through the mount bracket and make all necessary connections.

1. NETWORK CONNECTIONS – If you are using a PoE Switch, connect the camera using an Ethernet cable for both data and power.
2. NETWORK CONNECTIONS – If you are using a non-PoE switch, connect the camera to the switch using an Ethernet cable for data transmission and use a power adapter to power the camera.

Part number	Power Requirements	Power Consumption
DWC-MF5Wi4TWDMP	DC 12V, PoE IEEE 802.3af Class 3 (Adapter not included).	DC12V: max 5.9W PoE: max 7.2W
DWC-MF2Wi4TWDMP	DC 12V, PoE IEEE 802.3af Class 2 (Adapter not included).	DC12V: max 4.0W PoE: max 5.5W

## STEP 3 - INSTALLING THE CAMERA

1. Attach the main body to the mount bracket by tightening the lock screw.
2. The waterproof cap set comes with two rubber rings with different diameters. The black rubber ring has an internal diameter of  $\varnothing 0.15''$  ( $\varnothing 4\text{mm}$ ). The white rubber ring has an internal diameter of  $\varnothing 0.19''$  ( $\varnothing 5\text{mm}$ ). When using the waterproof cap, use the rubber ring best suited for your network cable's diameter.
  - a. Pass the LAN cable through the waterproof cap, gasket and the **a** rubber ring.
  - b. Connect the LAN cable to the camera's network port **b**.
  - c. **c** will be affixed to **b** with a  $\frac{1}{4}$  turn counter-clockwise.
  - d. Thread and twist **d** tightly to **c**.

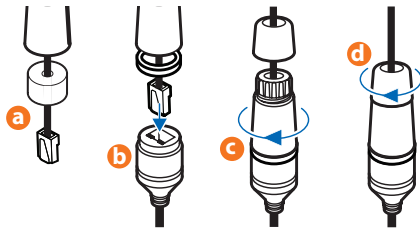

**NOTE:** To ensure moisture seal, make sure the o-ring is in place between **a** and **b**. In extreme environments use of an outdoor rated sealer is recommended.

**NOTE:** Cables with  $\varnothing 4.5\text{mm}$  to  $\varnothing 5.5\text{mm}$  thickness should use the black rubber ring. Cables over  $\varnothing 5.5\text{mm}$  in thickness should use the white rubber ring.

3. Once the installation is complete, adjust the camera's tilt, panning and rotation as needed. The cameras' max angles are:  
Pan:  $0^\circ \sim 360^\circ$   
Tilt:  $0^\circ \sim 70^\circ$   
Rotation:  $0^\circ \sim 360^\circ$
4. Assemble the dome cover over the camera body and detach the protecting film from the dome bubble.

**Resetting the camera:** To reset the camera, use the tip of a paper clip or a pencil and press the reset button. Pressing the button for five (5) seconds will initiate a camera-wide reset of all the settings, including network settings.

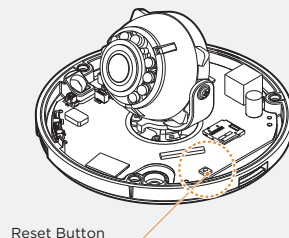

Reset Button

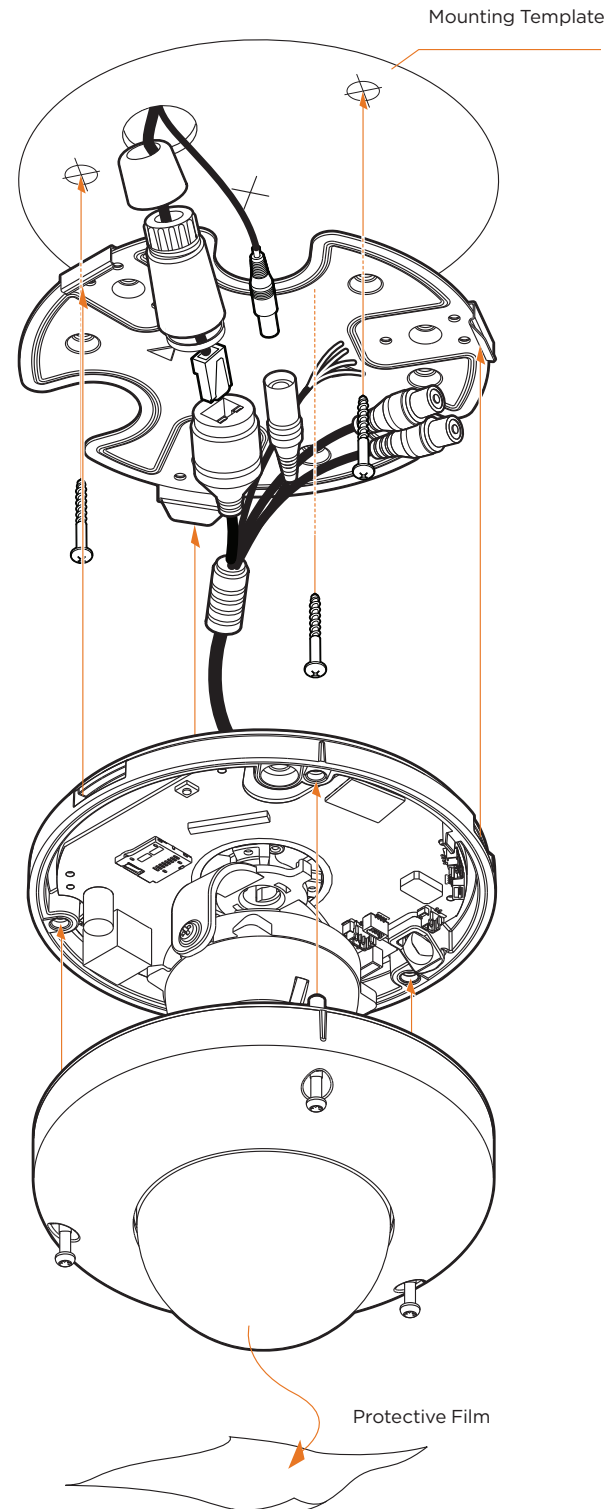

## STEP 3 - INSTALLING THE CAMERA (CONT.)

Installation using Mount Bolt and Screws:

1. Using the mounting template, mark and drill the holes on the mounting surface.
2. Secure the two long mounting screws to the camera's base.
3. Pass the wires through the mount bracket and make all necessary connections.
4. Mount the camera to the mounting surface by using the 2 mounting nuts. Rotate the locking discs over the screws until the camera is held tightly from the mounting surface.

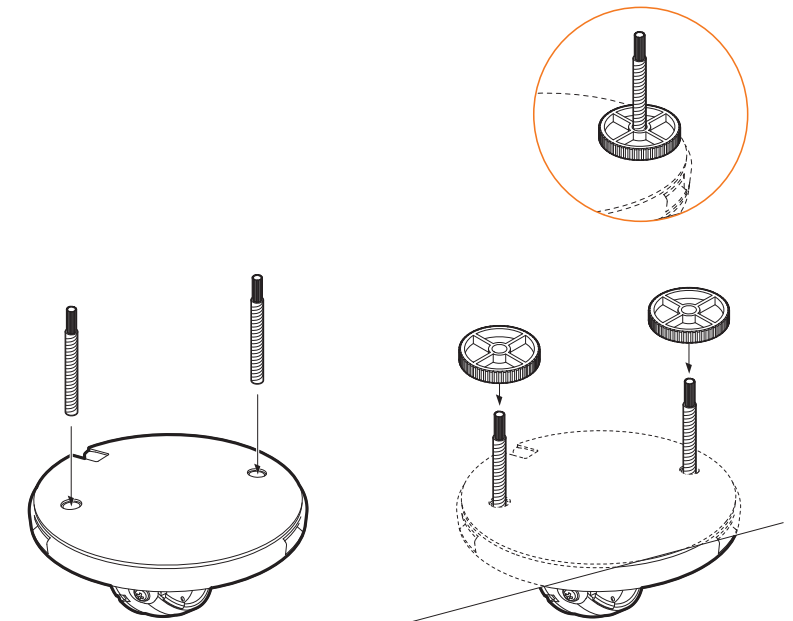

**NOTE:** Please refer to DMP guide for additional information on integration and camera control.